

WENZHOU KAI XU AUTOMOBILE FITTING CO., LTD

DIN472 (KX-DK 8-52) (spring retaining ring for bore孔用弹性挡圈)

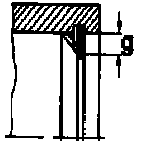
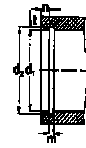
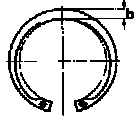
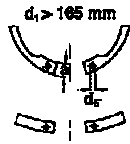

公称直径 d1	内径 d3		厚度 S		槽直径 d2		槽宽 m min	孔径 d5 min	头宽 a max	尾宽 b ≈	重量 公斤/千 只							
	基本尺寸	极限偏差	基本尺寸	极限偏差	基本尺寸	极限偏差												
8	8.7	+0.36 -0.10	0.80	-0.05	8.4	+0.09	0.90	1.0	2.4	1.1	0.10							
9	9.8				9.4				0.13									
10	10.8				1.00				-0.06			10.4	+0.11	1.10	1.2	3.2	1.4	0.26
11	11.8											11.4				0.31		
12	13.0											12.5				0.37		
13	14.1											13.6				1.8	0.42	
14	15.1											14.6						2.0
15	16.2											15.7				2.1	0.56	
16	17.3											16.8						2.2
17	18.3											17.8				2.3	0.65	
18	19.5	19.0	2.4	0.74														
19	20.5	20.0				2.5	0.73											
20	21.5	21.0	2.6	0.90														
21	22.5	22.0			2.7	1.00												
22	23.5	23.0	2.8	1.10														
23	24.6	24.1			2.9	1.34												
24	25.9	25.2	3.0	1.42														
25	26.9	26.2			3.1	1.50												
26	27.9	27.2	3.2	1.60														
27	29.1	28.4			3.3	1.75												
28	30.1	29.4	3.4	1.80														
29	31.1	30.4			3.5	1.88												
30	32.1	31.4	3.6	2.06														
31	33.4	32.7			3.7	2.10												
32	34.4	33.7	3.8	2.21														
33	35.5	34.7			3.9	2.40												
34	36.5	35.7	4.0	2.40														
35	37.8	37.0			4.1	3.20												
36	38.8	38.0	4.2	3.54														
37	39.8	39.0			4.3	3.70												
38	40.8	40.0	4.4	3.74														
39	42.0	41.0			4.5	3.90												
40	43.5	42.5	4.6	4.00														
41	44.5	43.5			4.7	4.70												
42	45.5	44.5	4.8	5.10														
43	46.5	45.5			4.9	5.40												
44	47.5	46.5	5.0	5.60														
45	48.5	47.5			5.1	5.80												
46	49.5	48.5	5.2	6.00														
47	50.5	49.5			5.3	6.05												
48	51.5	50.5	5.4	6.10														
50	54.2	53.0			5.5	6.70												
51	55.2	54.0	5.6	7.30														
52	56.2	55.0			5.7	7.75												
53	57.2	56.0	5.8	8.20														
								6.7			8.22							

WENZHOU KAI XU AUTOMOBILE FITTING CO., LTD

DIN472 (KX-DK 53-127) (spring retaining ring for bore孔用弹性挡圈)

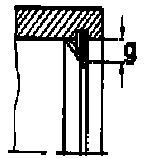
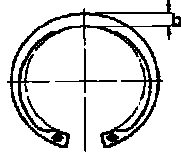
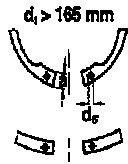

公称直径 d ₁	内径 d ₃		厚度 S		槽直径 d ₂		槽宽 m min	孔径 d ₅ min	头宽 a max	尾宽 b ≈	重量 公斤/千 只
	基本 尺寸	极限 偏差	基本 尺寸	极限 偏差	基本 尺寸	极限 偏差					
54	58.2	+1.10 -0.46	2.0	-0.07	57.0	+0.30	2.15	2.5	6.7	5.0	8.25
55	59.2				6.8				5.1		8.30
56	60.2				6.9					5.2	8.80
57	61.2								7.3		5.4
58	62.2				7.4					5.5	
60	64.2								7.6		5.6
62	66.2				7.7					5.7	
63	67.2								7.8		5.8
64	68.2				7.8					6.0	
65	69.2								7.8		6.1
67	71.5				7.8					6.2	
68	72.5								7.8		6.4
70	74.5				7.8					6.6	
72	76.5								7.8		6.8
75	79.5	+1.30 -0.54	2.5	-0.07	78.0	+0.35	2.65	3.0		6.6	
77	82.5				8.5				6.8	20.40	
78	82.5									8.5	7.0
80	85.5				8.6				7.4		
81	86.5									8.6	7.6
82	87.5				8.7				7.8		
83	88.5									8.8	8.1
85	90.5				8.7				7.8		
87	93.5									8.8	8.1
88	93.5				9.0				8.3		
90	95.5									9.2	8.4
92	97.5				9.2				8.4		
95	100.5									9.5	8.5
97	103.5				9.5				8.7		
98	103.5	9.5	8.9	41.00							
100	105.5			9.5	9.0	42.00					
102	108.0	9.5	9.1			44.00					
105	112.0			9.5	9.3	46.00					
107	115.0	9.5	9.5			46.00					
108	115.0			9.5	9.6	60.00					
110	117.0	9.5	9.7			60.00					
112	119.0			9.5	9.8	64.50					
115	122.0	9.5	9.8			72.00					
117	125.0			9.5	9.8	74.50					
118	125.0	9.5	9.8			75.50					
120	127.0			9.5	9.8	75.50					
122	129.0	9.5	9.8			77.00					
125	132.0			9.5	9.8	78.00					
127	135.0	9.5	9.8			79.00					
				9.5	9.8	81.00					

WENZHOU KAI XU AUTOMOBILE FITTING CO., LTD

DIN472 (KX-DK 128-215) (spring retaining ring for bore孔用弹性挡圈)

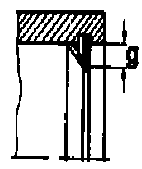
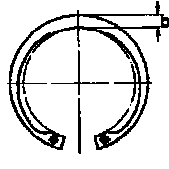
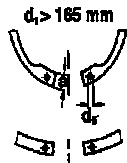

公称直径 d ₁	内径 d ₃		厚度 S		槽直径 d ₂		槽宽 m min	孔径 d ₅ min	头宽 a max	尾宽 b ≈	重量 公斤/千 只
	基本 尺寸	极限 偏差	基本 尺寸	极限 偏差	基本 尺寸	极限 偏差					
128	135.0	+1.50 -0.63	4.00	-0.10	132.0	+0.63	4.15	4.0	11.0	10.2	81.00
130	137.0				134.0						82.00
132	139.0				136.0				83.00		
135	142.0				139.0				84.00		
137	145.0				141.0				86.00		
138					142.0				86.00		
140	147.0				144.0				87.50		
142	149.0				146.0				89.00		
145	152.0				149.0				93.00		
147	155.0				151.0				100.00		
148					152.0				100.00		
150	158.0				155.0				105.00		
152	161.0				157.0				106.00		
155	164.0				160.0				107.00		
157	167.0				162.0				109.00		
158	167.0				163.0				109.00		
160	169.0				165.0				110.00		
162	171.5				167.0				118.00		
165	174.5				170.0				125.00		
167	177.5				172.0				135.00		
168	177.5				173.0					135.00	
170	179.5				175.0				140.00		
172	181.5				177.0				145.00		
175	184.5				180.0				150.00		
177	187.5				182.0				162.00		
178	187.5				183.0				162.00		
180	189.5				185.0				165.00		
182	191.5				187.0				168.00		
185	194.5	190.0	170.00								
187	197.5	192.0	174.00								
188	197.5	193.0		174.00							
190	199.5	195.0	175.00								
192	201.5	197.0	178.00								
195	204.5	200.0	183.00								
197	207.5	202.0	190.00								
198	207.5	203.0		190.00							
200	209.5	205.0	195.00								
202	214.0	208.0	210.00								
205	217.0	211.0		210.00							
207	217.0	213.0	225.00								
208	222.0	214.0	225.00								
210	222.0	216.0	270.00								
212	222.0	218.0	270.00								
215	227.0	221.0	300.00								

WENZHOU KAI XU AUTOMOBILE FITTING CO., LTD

DIN472 (KX-DK 217-305) (spring retaining ring for bore孔用弹性挡圈)

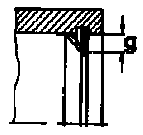
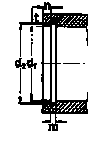
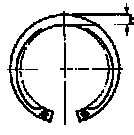
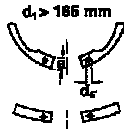

公称直径 d ₁	内径 d ₃		厚度 S		槽直径 d ₂		槽宽 m min	孔径 d ₅ min	头宽 a max	尾宽 b ≈	重量 公斤/千 只
	基本尺寸	极限偏差	基本尺寸	极限偏差	基本尺寸	极限偏差					
217	227.0	+1.70 -0.72	5.00	-0.12	223.0	0.72	4.0	14.2	14.0	300.00	
218	232.0				224.0						315.00
220					226.0						315.00
222					228.0						315.00
225	237.0				231.0						323.00
227					233.0						323.00
228					234.0						330.00
230	242.0				236.0						330.00
232					238.0						330.00
235					247.0						241.0
237	243.0										338.00
238	244.0										345.00
240	252.0				246.0						345.00
242					248.0						345.00
245					257.0						251.0
247	253.0										353.00
248	254.0										360.00
250	262.0				256.0						360.00
252		260.0	360.00								
255		270.0	263.0	368.00							
257	265.0		368.00								
258	266.0		375.00								
260	275.0	268.0	375.00								
262		270.0	375.00								
265		280.0	273.0	383.00							
267	275.0		383.00								
268	276.0		388.00								
270	285.0	278.0	388.00								
272		280.0	388.00								
275		290.0	283.0	393.00							
277	285.0		393.00								
278	286.0		400.00								
280	295.0	288.0	400.00								
282		290.0	400.00								
285		300.0	293.0	408.00							
287	295.0		408.00								
288	296.0		415.00								
290	305.0	298.0	415.00								
292		300.0	415.00								
295		310.0	303.0	426.00							
297	305.0		426.00								
298	306.0		435.00								
300	308.0	435.00									
305	322.0	+2.00 -0.90	6.00	-0.15	315.0		6.20	6.0		20.0	755.00

WENZHOU KAI XU AUTOMOBILE FITTING CO., LTD

DIN472 (KX-DK 310-1000) (spring retaining ring for bore孔用弹性挡圈)

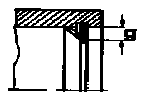
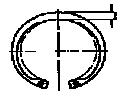

公称直径 d ₁	内径 d ₃		厚度 S		槽直径 d ₂		槽宽 m min	孔径 d ₅ min	头宽 a max	尾宽 b ≈	重量 公斤/千 只
	基本 尺寸	极限 偏差	基本 尺寸	极限 偏差	基本 尺寸	极限 偏差					
310	327.0	+2.00 -0.90	6.00		320.0	0.89	6.20			20.0	770.00
315	332.0				325.0						785.00
320	337.0				330.0						800.00
325	342.0				335.0						810.00
330	347.0				340.0						820.00
335	352.0				345.0						830.00
340	357.0				350.0						840.00
345	362.0				355.0						855.00
350	367.0				360.0						870.00
355	372.0				365.0						880.00
360	377.0				370.0						890.00
365	382.0				375.0						906.00
370	387.0				380.0						920.00
375	392.0				385.0						932.00
380	397.0				390.0						940.00
385	402.0				395.0						950.00
390	407.0				400.0						960.00
395	412.0				405.0						972.00
400	417.0				410.0						980.00
410	430.0				+2.00 -1.00						7.00
420	440.0	432.0	1410.00								
430	450.0	442.0	1440.00								
440	460.0	452.0	1470.00								
450	470.0	462.0	1510.00								
460	480.0	472.0	1550.00								
470	490.0	482.0	1595.00								
480	500.0	492.0	1640.00								
490	510.0	502.0	1685.00								
500	520.0	512.0	1730.00								
510	535.0	+3.00 -1.50	8.00		524.0	8.20				34.0	2250.00
520	545.0				534.0						2290.00
530	555.0				544.0						2335.00
540	565.0				554.0						2380.00
550	575.0				564.0						2430.00
560	585.0				574.0						2495.00
570	595.0				584.0						2560.00
580	605.0				594.0						2625.00
590	615.0				604.0						2700.00
600	625.0				614.0						2770.00
650	680.0	+4.00 -2.00	9.00	-0.20	666.0	9.30	9.0				3600.00
700	730.0				716.0						4120.00
750	785.0				768.0						4540.00
800	835.0				818.0						5450.00
850	890.0				870.0						5990.00
900	940.0				920.0						6740.00
950	1000.0				972.0						7930.00
1000	1050.0				1022.0						8880.00